



THseries TH312 TH312A

Two-way Loudspeaker System

TH312 is a dual 12", big power, high sensitivity, high SPL, long-throw speaker. Mid-bass and HF driver all feature horn-loaded design. Unit configuration: 2x12" high efficiency neodymium mid-bass units, 1x1.4" exit throat 75mm voice coil neodymium HF driver. The cabinet is made of multilayer composite plywood with wear-resistant polyurea paint. TH312A is equipped with two channels digital amplifier with DSP based on TH312 to be an active speaker.

TH312是一款双12"大功率，高声压级中远程音箱。中低音与高音全部采用号角负载设计，整只音箱有较高的灵敏度，单元配置：2只12寸钕磁高效率中低音单元，1只1.4寸喉口75芯钕磁复合振膜驱动器，箱体采用多层复合夹板，耐磨聚脲喷涂。TH312A是在TH312的基础上配置两通道D类带DSP的功放成为有源音箱。

FEATURES

- Compact cabinet design
- All horn-loaded design
- High SPL
- Applications: theatres, concert halls, multifunction halls, lecture halls, bars, live houses, large-scale sound reinforcement and touring

产品特点

- 紧凑型箱体设计，全部号角负载设计，高声压级输出

适用范围

- 剧院、音乐厅、多功能厅、报告厅
- 酒吧、LIVE HOUSE
- 大型场景补声
- 流动演出



CONFIGURATION

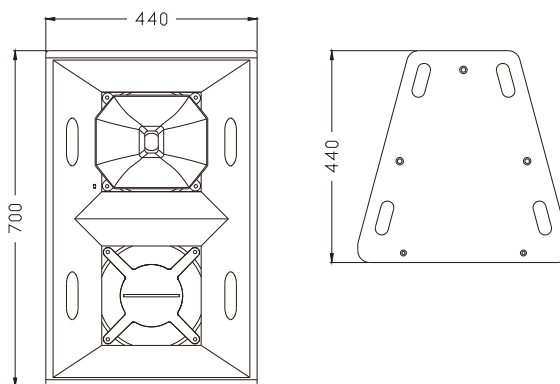

MODEL

FREQUENCY RESPONSE(-3dB)

FREQUENCY RESPONSE(-10dB)

DRIVERS

RATED POWER

SENSITIVITY

MAXIMUM SPL

IMPEDANCE

DISPERSION(-6dB)

CROSSOVER FREQUENCIES

INPUT CONNECTORS

PACKAGE SIZE

NET WEIGHT

GROSS WEIGHT

TH312

65Hz-18kHz

60Hz-20kHz

2×12"(300mm)/3"voice coil LF

1×1.4"(36mm)/3"voice coil HF

600W RMS,2400W peak

103dB 1watt/1meter

131dB continuous,137dB peak

4 ohms nominal

60°×40°

1.3kHz passive

2×Speakon NL4

530mm×530mm×795mm

32 kg/pc

37 kg/pc

TH312A

65Hz-18kHz

60Hz-20kHz

2×12"(300mm)/3"voice coil LF

1×1.4"(36mm)/3"voice coil HF

300W/8Ω+1200W/4Ω

--

131dB continuous,137dB peak

--

60°×40°

--

INPUT TYPE: Balanced Differential line

530mm×530mm×795mm

35 kg/pc

40 kg/pc